

## Features:

- \* Available in 02 through 12 Circuits
- \* Material: Nylon 66 UL94V-2
- \* Mates with YY-2900-HXX Series Housing
- \* 1.14mm(.045") Squard Pin
- \* Pin Material: Brass/Tin-Plated

## Ordering information:

2900-W XX S X F  
I 2 3 4 5

- 1 W=Wafer
- 2 No. of Circuits 02~12
- 3 S=Straight
- 4 Plated: T=Tin G=Gold
- 5 F:Without Backrest

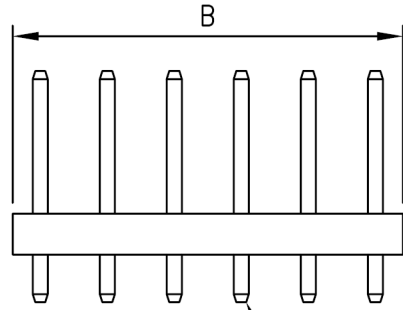
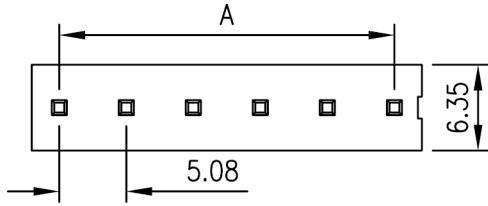

Pin 1.14 SQ

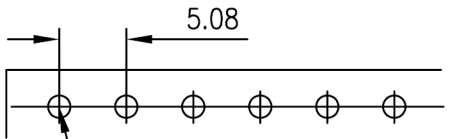

P.C.B Thickness 0.80~1.60mm  
P.C.B Hole dia  $\phi 1.80\text{mm} \pm 0.05$

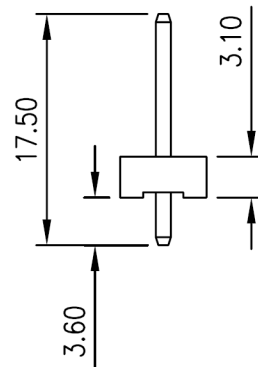

Circuits	Dimension mm	
	A	B
2	5.08	10.16
3	10.16	15.24
4	15.24	20.32
5	20.32	25.40
6	25.40	30.48
7	30.48	35.56
8	35.56	40.64
9	40.64	45.72
10	45.72	50.80
11	50.80	55.88
12	55.88	60.96

the **vital**  
component