



CULUS E182481



REV	DESCRIPTION	DATE
A1	EN980703-2	2009.07.03

NOTES

Used in 1800-H & 1900-H
& 1920-H Series Housing
(01~19 Pin are available)

Accepts AWG #22~28 Wire Range
Insulation O.D.= 1.70mm(max)
Material : Brass or Phosphor bronze
Finished : Gold-Plated
Qty/Reel : 10,000 PCS
Thickness: 0.2mm

ORDERING INFORMATION

1800 - $\frac{T}{1}$

1. T : Terminal

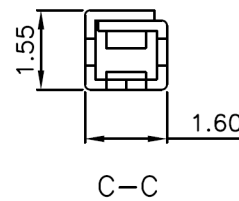
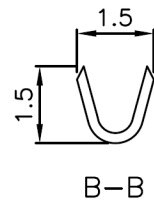
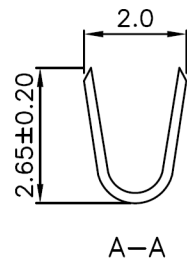
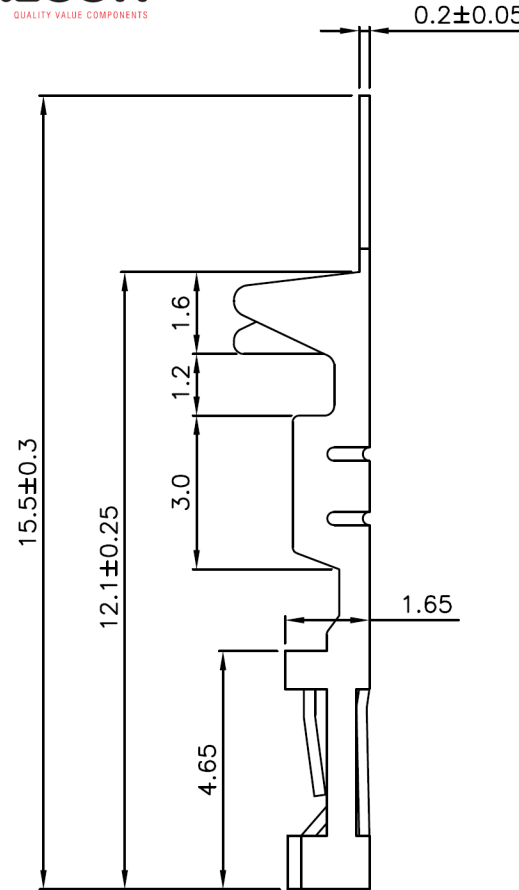
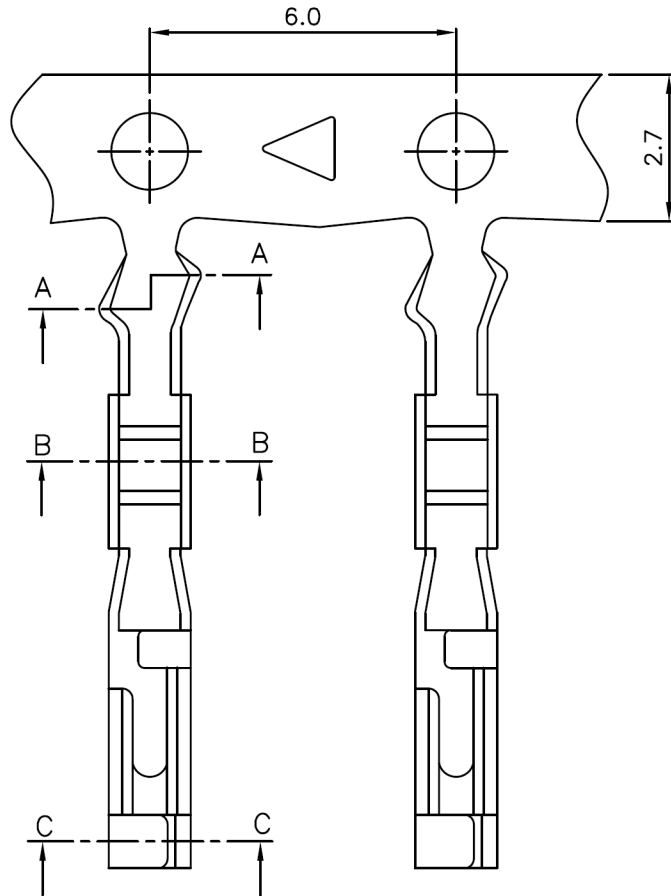

TOLERANCE	
X.	--
X.X	±0.20
X.XX	±0.10
X.XXX	±0.05
ANGULAR	--

the **vital** component

TITLE
2.54mm(.100") Pitch
Wire to Board Terminal

APPROVALS

DRAWN	VIEW	SCALE	PART NO.	REV.
Frank 03-JULY-2009		F	1800-T	A1
CHECKED	UNIT	SIZE	DWG NO.	SHEET
Denise 03-JULY-2009	MM	A4	1800-T	1 OF 1
APPROVED				
Jessica 03-JULY-2009				