

TA-Hx-Dx-BG Series HDMI to DVI Adapters

- Black PVC
- Gold plated contacts and shells
- HDMI & DVI Approved connector design
- Fully compliant with HDMI version 1.2a (where applicable)
- Go to www.toby.co.uk for pin assignment and full specification

TA-HF-DF-BG ~ HDMI Receptacle to 24+1 DVI Female

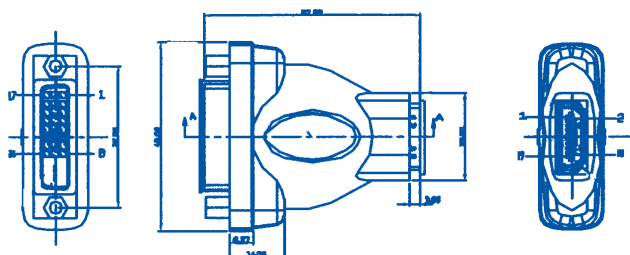

TA-HM-DF-BG ~ HDMI Male Plug to 24+1 DVI Female

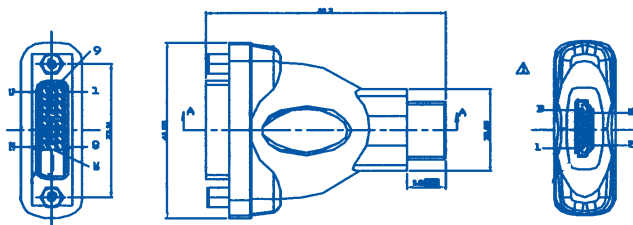

TA-HF-DM-BG ~ HDMI Receptacle to 18+1 DVI Male Plug

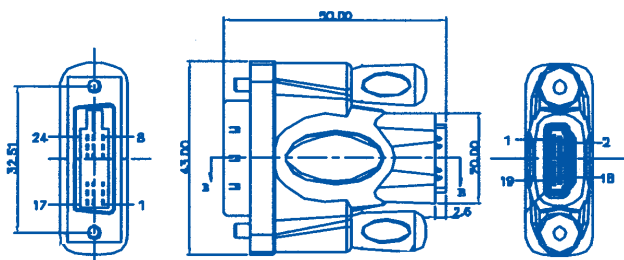

Adapter Pin Assignment ~ HDMI to DVI

PIN ASSIGNMENT:

DVI(24+1)F CONN.	HDMI 19P CONN.	DVI(24+1)F CONN.	HDMI 19P CONN.
1	3 (TMDS Data 2-)	14	18(+5V Power)
2	1 (TMDS Data 2+)	15	17(Ground)
3	2 (TMDS Data 2 Shield)	6	15(DDC Clock)
9	6 (TMDS Data 1-)	7	16(DDC Data)
10	4 (TMDS Data 1+)	16	19(Hot Plug Detect)
11	5 (TMDS Data 1 Shield)	SHELL	SHELL
17	9 (TMDS Data 0-)		
18	7 (TMDS Data 0+)		
19	8 (TMDS Data 0 Shield)		
24	12 (TMDS Clock -)		
23	10 (TMDS Clock +)		
22	11 (TMDS Clock Shield)		

Specification for TA-Hx-Dx-BG Series

Overmould:	Black PVC 45 Pa UL94V-0
Innermould:	PE Low Density
HDMI Connectors:	19 Pin Male 30U"/AU Gold Plated 19 Pin Female 30U"/AU Gold Plated
DVI Connectors:	18+1 Plug Gold Plated 24+1 Socket Gold Plated
Shell Plating:	Gold Plated
Current Rating:	DC 1 Amp
Withstanding Voltage:	DC 300V
Insulation Resistance:	50 Mohm min.
Conductive Resistance:	2 Ohm Max.
Thumbscrew Thread:	4-40 unc
Internal Wire Spec.:	UL1007 28 AWG
Cable Specification:	UL20276 28 AWG
Impedance:	100 Ohm

Ordering Information for TA-Hx-Dx-BG Series

Part Number	Adapter Type
TA-HF-DM-BG	HDMI Receptacle to 18+1 DVI Male Plug
TA-HM-DF-BG	HDMI Male Plug to 24+1 DVI Female
TA-HF-DF-BG	HDMI Receptacle to 24+1 DVI Female