

### 3.96mm Pitch Single Row 5 Amp PCB Headers - Straight PCB Mount with Backwall WH396-xx-S-010 Series

Single row 3.96mm pitch straight PCB mount headers with locking backwall  
Tin plated contacts (1.14mm diameter pins)  
Mates with Valcon WH396-xx-H series housings (& crimps)

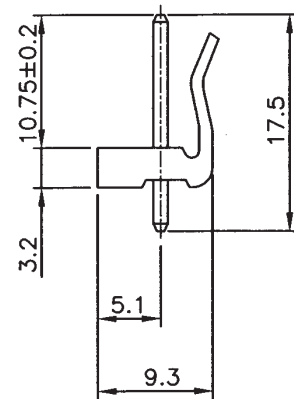
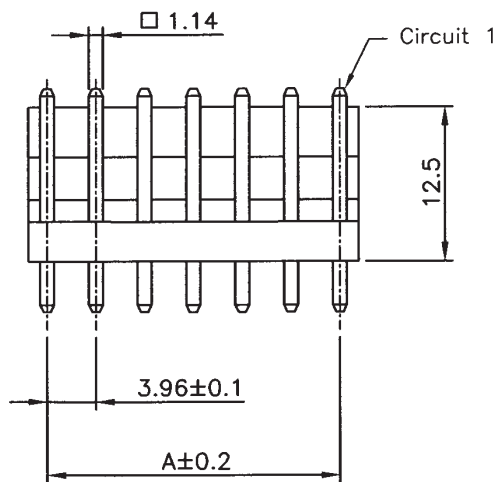
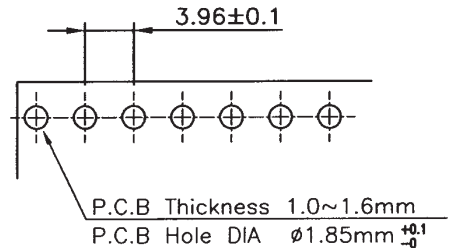
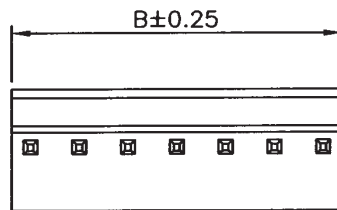
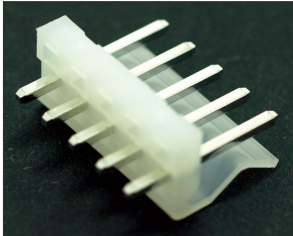

Circuits	Dimension mm		Circuits	Dimension mm		Circuits	Dimension mm	
	A	B		A	B		A	B
2	3.96	7.92	9	31.68	35.64	16	59.40	63.36
3	7.92	11.88	10	35.64	39.60	17	63.36	67.32
4	11.88	15.84	11	39.60	43.56	18	67.32	71.28
5	15.84	19.80	12	43.56	47.52	19	71.28	75.24
6	19.80	23.76	13	47.52	51.48	20	75.24	79.20
7	23.76	27.72	14	51.48	55.44	--	--	--
8	27.72	31.68	15	55.44	59.40	--	--	--

#### Ordering Information:

**WH396- xx - S - 010**

**1**

#### Option 1(xx)

Number of contacts (in total)  
**02,03,04,05,06,07,08,09,10,11,  
12,13,14,15,16,17,18,19 & 20**

*Please note - some sizes may be subject to MOQ*

#### Specification:

Insulator Material:	Clear Nylon 66 UL94V-2
Contact Material:	Brass
Contact Plating:	Tin
Pin Type:	1.14mm (0.045") square pin
Current Rating:	5 Amps
Rated Voltage:	250V AC/DC
DWV:	1500V AC for 1 minute
Insulation Resistance:	1000 MΩ min.
Operating Temperature:	-25°C to +85°C
Tolerance:	±0.35mm