

MOUNTING HOLE $\phi 3.2$
THICKNESS 1.6mm

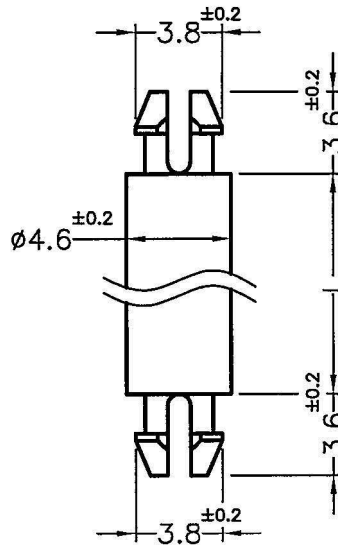

MOUNTING HOLE $\phi 3.2$
THICKNESS 1.6mm

PART NO.	L
MSPS3-1.2	1.2
MSPS3-3.2	3.2
MSPS3-4	4.0
MSPS3-4.8	4.8
MSPS3-6.4	6.4
MSPS3-8.7	8.7
MSPS3-9.5	9.5
MSPS3-11.1	11.1
MSPS3-12.7	12.7
MSPS3-14.3	14.3
MSPS3-15.9	15.9
MSPS3-19.1	19.1
MSPS3-20.6	20.6
MSPS3-22.2	22.2
MSPS3-25.4	25.4
MSPS3-31.8	31.8
MSPS3-34.9	34.9

NOTE:1. SHRINKING IS NORMAL STATUS.
2. MADE OF EQUIVALENT MATERIAL.

TOBY ELECTRONICS LTD
sales@toby.co.uk | toby.co.uk

VALCON
QUALITY VALUE COMPONENTS

PROPRIETARY AND CONFIDENTIAL THE INFORMATION CONTAINED IN THIS DRAWING IS THE SOLE PROPERTY OF TOBY ELECTRONICS MANUFACTURING PARTNER. ANY REPRODUCTION IN PART OR AS A WHOLE WITHOUT THE WRITTEN PERMISSION OF TOBY ELECTRONICS MANUFACTURING PARTNER IS STRICTLY PROHIBITED	DATE	2013.08.01	TITLE	SPACER SUPPORT	DWG. NO.	MSPS3-...	PART NO.	SEE ABOVE
	DRAWN	T. C	MATERIAL	NYLON 66 UL94V-2				
	CHECKED		COLOR	NATURAL	FINISH			
	APPROVED		UNLESS OTHERWISE SPECIFIED TOLERANCE: SEE ABOVE		SIZE	A4	SPEC. DWG	REV
DO NOT SCALE DRAWING					SCALE: 3:1	UNIT	mm	SHEET 1 OF 1