

VLT-6 Series SMD Wiring Terminal

6mm pin spacing



Item No.:VLT-6-S-H-01-TR

Item No.:VLT-6-S-H-02-TR

Item No.:VLT-6-S-H-03-TR

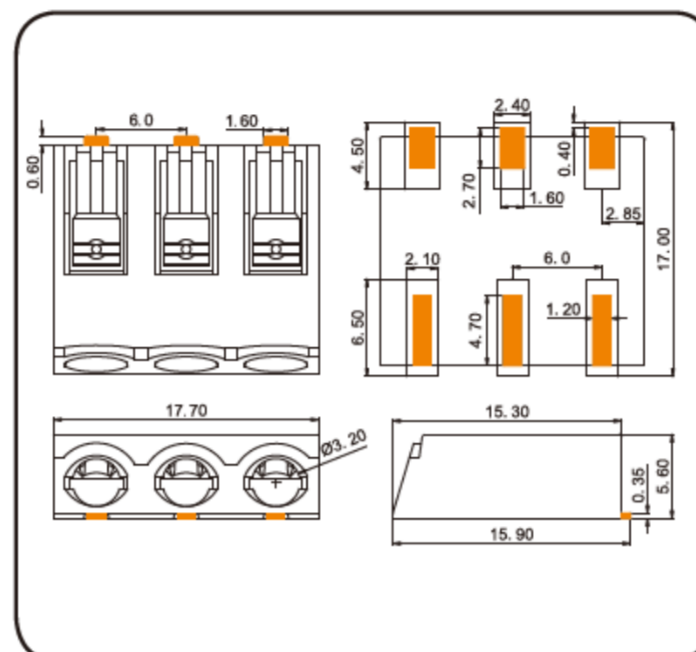
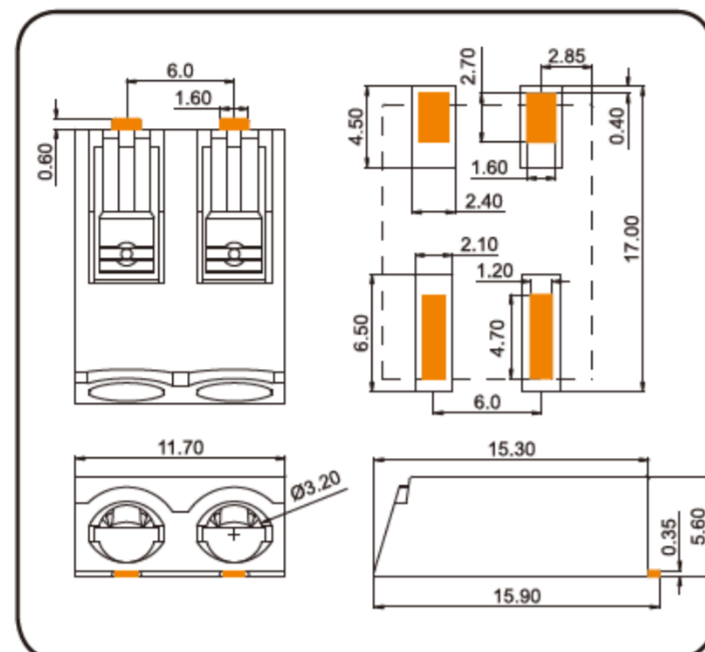
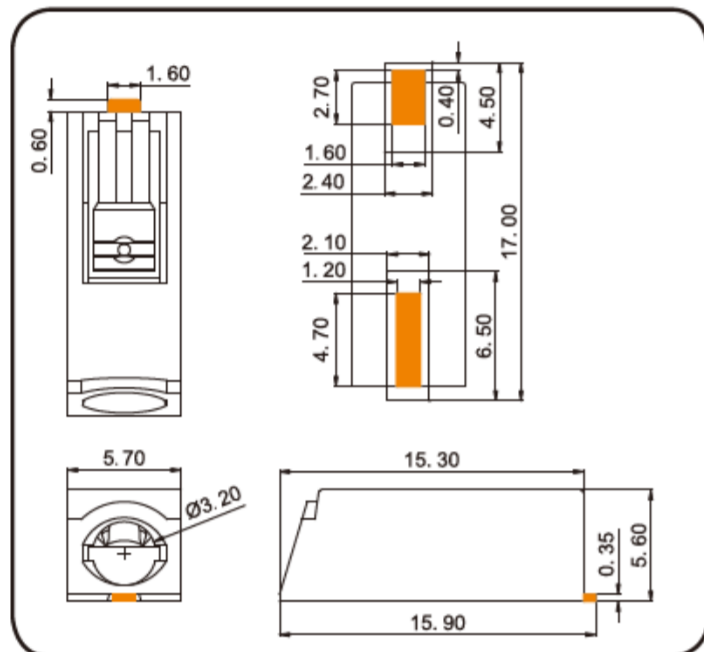

Pin Spacing	6 mm/0.24 in.		
Rating per	IEC/EN 60664-1		
Overvoltage category	III	III	II
Pollution degree	3	2	2
Rated voltage	250V	320V	630V
Rated surge voltage	4KV	4KV	4KV
Nominal current	18A	18A	18A
Conductor data:			
Connection technology	CAGE CLAMP		
Conductor size: solid	0.50 - 1.5 mm ²		
Conductor size: fine-stranded	0.50 - 1.5 mm ²		
AWG	20 - 16		

SMT

Surface Mount Technology (SMT) means soldering electronic components directly onto PCB surface pads without drilling holes. The basic SMT process consists of applying solder paste to the PCB via solder dispensing equipment, screen or stencil printing. SMT assembly is performed using fully automated placement machines.

The SMD components are soldered to the board in infrared, convection or vapor phase ovens.

Reflow Soldering Process:

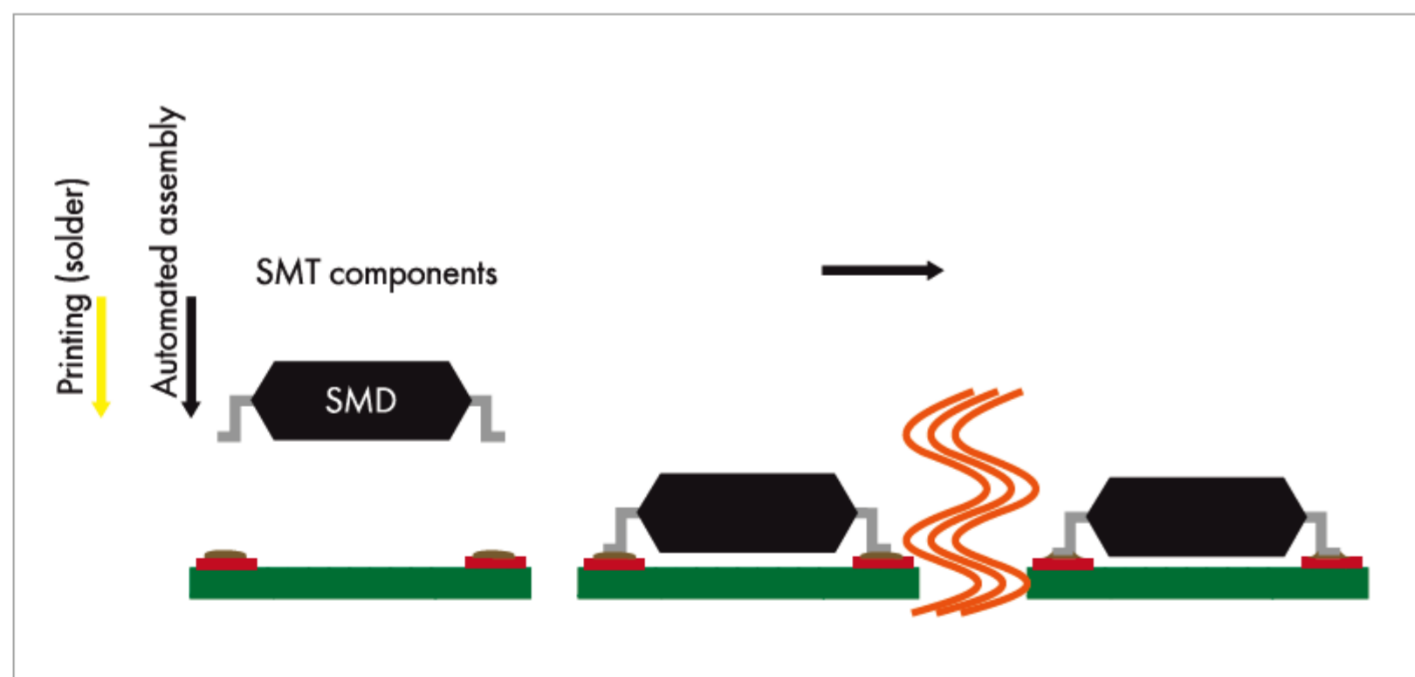

Inserting solid conductors via push-in termination.

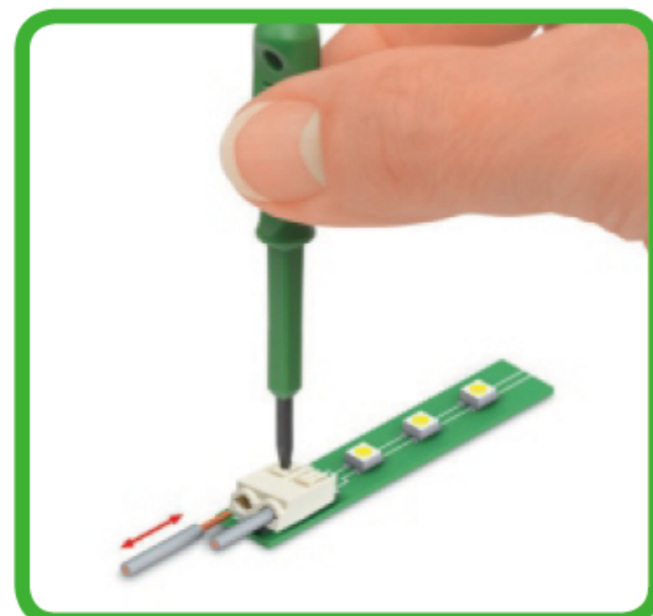

Inserting/removing fine-stranded conductors by lightly pressing on push-button

