

VLT-4 SERIES SMD Wiring Terminal

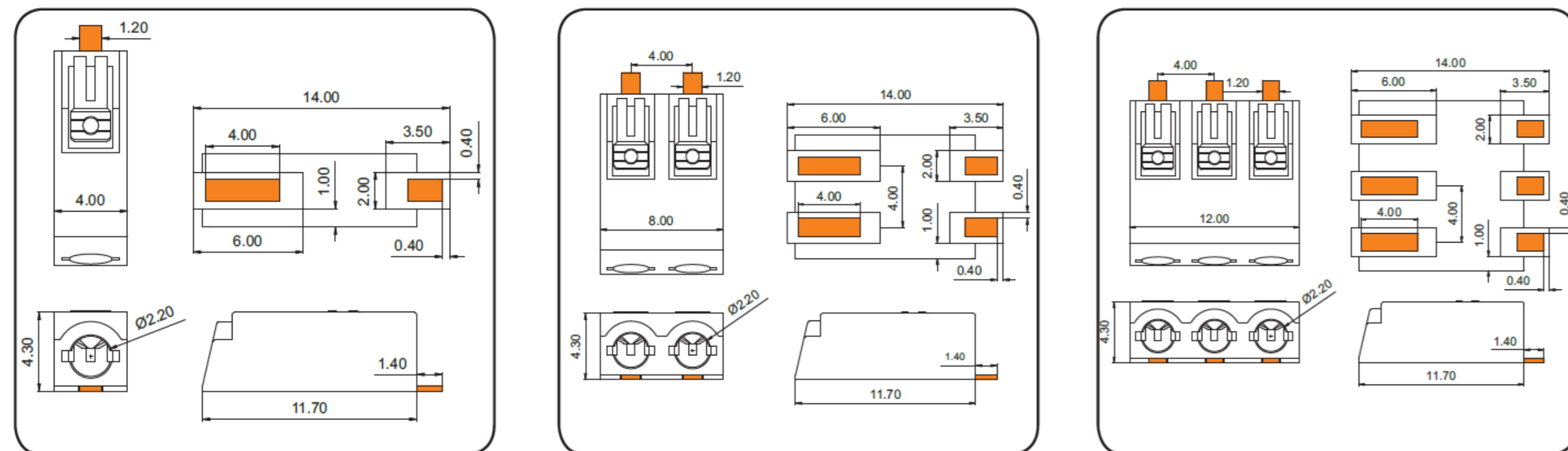

- SMD terminal strips with CAGE CLAMP^{®S} connection and push-buttons
- Direct push-in of solid conductors
- Push button for connection of stranded conductors, and for removal of all wire types
- A total height of only 4.5mm helps minimize shadowing in LED applications
- Packaged in tape-and-reel for automated assembly
- Large flat area for easy pick-n-place
- Wiring ports with balcony design - creates "lead-in" for ease of wiring, even at a slight angle

Technical data:		Conductor data:		Material data:	
Pin Spacing	4 mm 0.157 in	Connection technology	CAGE CLAMP ^{®S}	Material group	I
Rating per	IEC/EN 60664-1	Conductor size: solid	0.20 - 0.75 mm ²	Insulating material	Glass fiber-reinforced polyphthalamide (PPA-GF)
Overtoltage category	III III II	Conductor size: fine-stranded	0.20 - 0.75 mm ²	Temperature stability	-35°C to +105°C
Pollution degree	3 2 2	AWG	24 - 18	Flammability rating per UL 94	V0
Rated voltage	63 V 160 V 320 V	Strip length	6 - 7 mm / 0.24 - 0.28 in	Contact plating	tin-plated
Rated surge voltage	2.5 kV 2.5 kV 2.5 kV	Conductor entry angle	0° to PCB		
Nominal current	9 A 9 A 9 A				
Approvals per	UL 1977				
Rated voltage	600 V				
Nominal current UL	9 A				

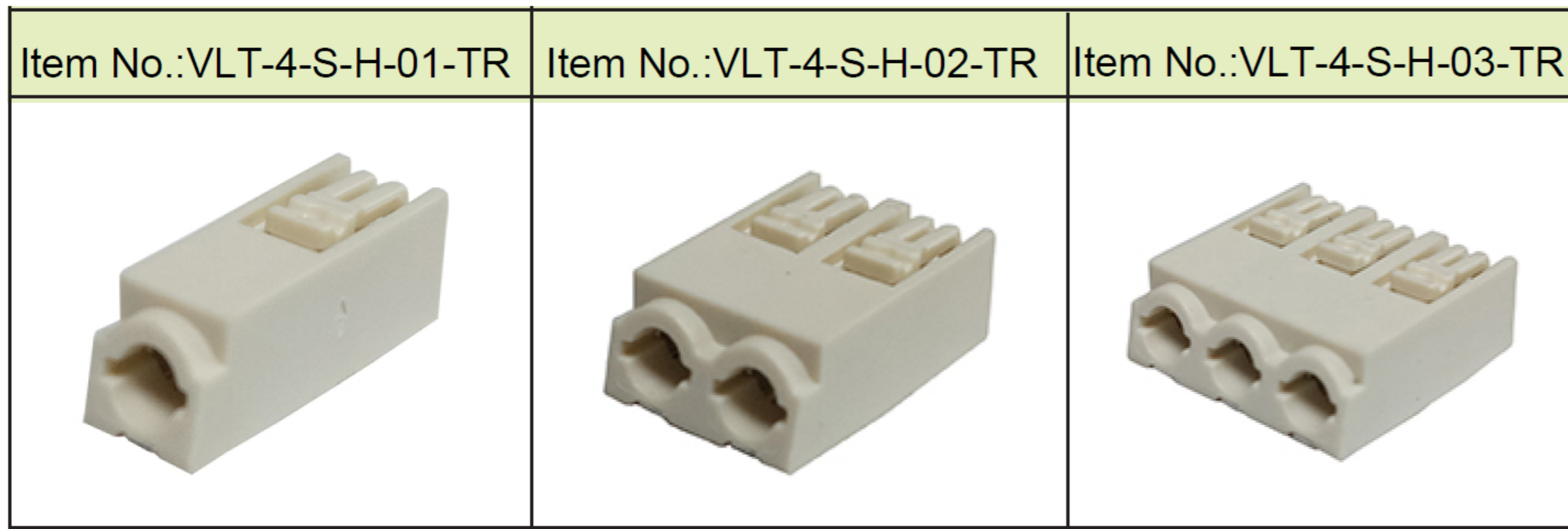
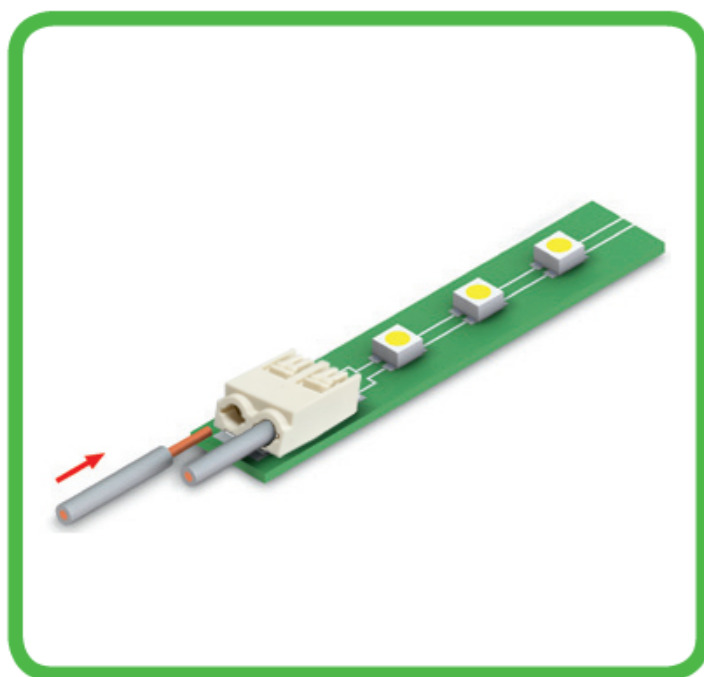

Inserting solid conductors via push-in termination.

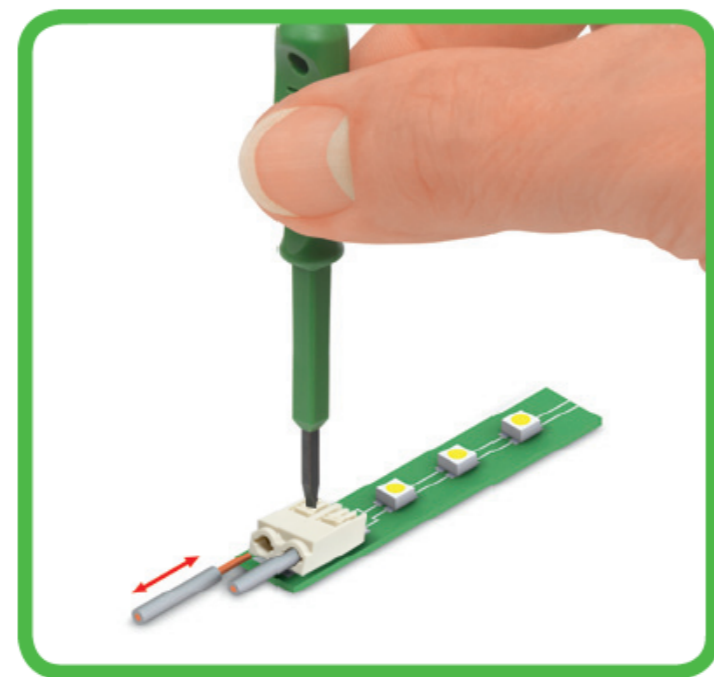

Inserting/removing fine-stranded conductors by lightly pressing on push-button

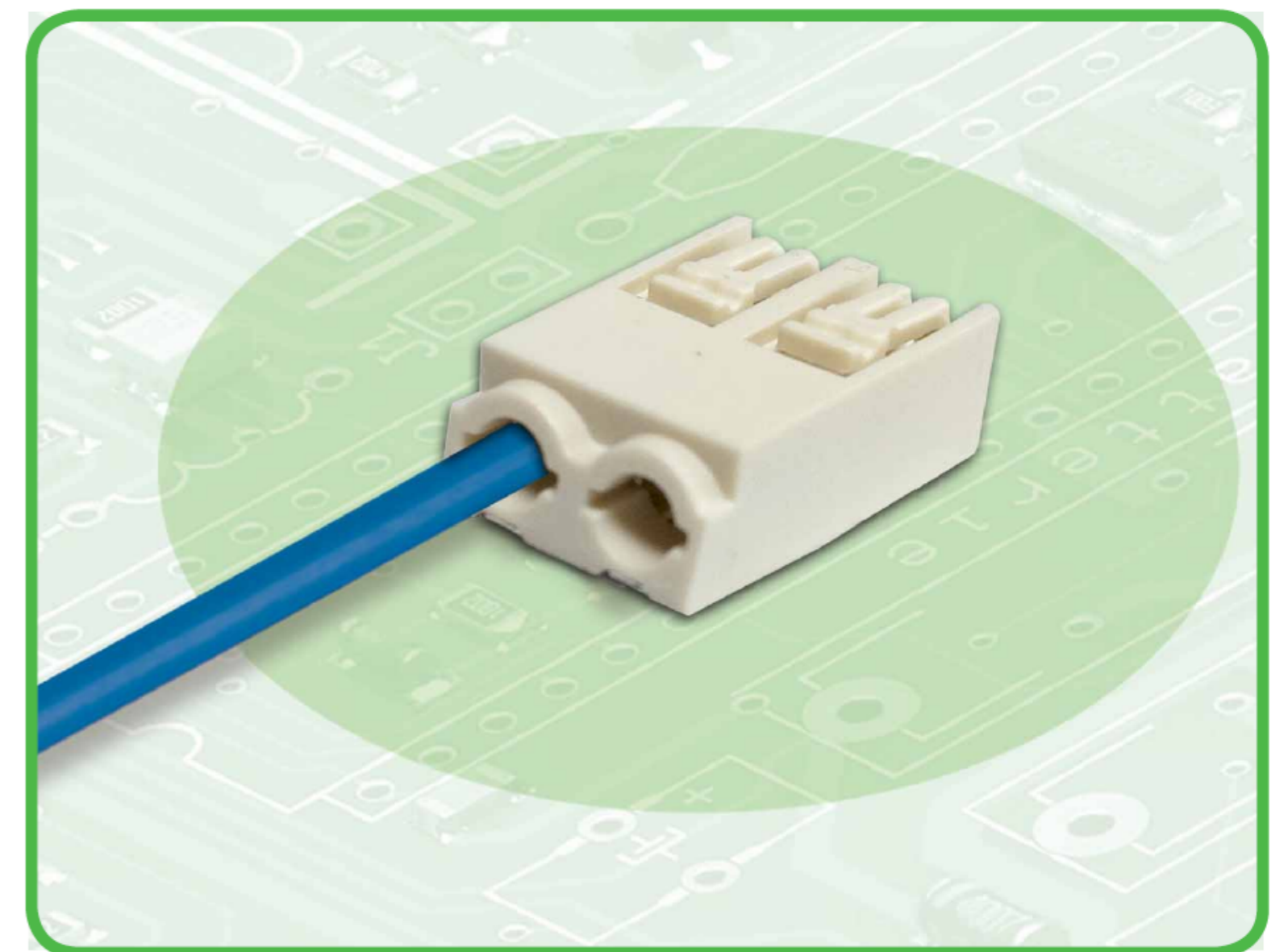

SMD terminal strip with push-buttons in tape-and-reel packaging, light gray*

Reel diameter: 330 mm

