

DIM.	TOL
5mmDOWN	±0.2
5~20mm	±0.3
20~40mm	±0.4
40~60mm	±0.5
60~100mm	±0.8
100mmUP	±1.0

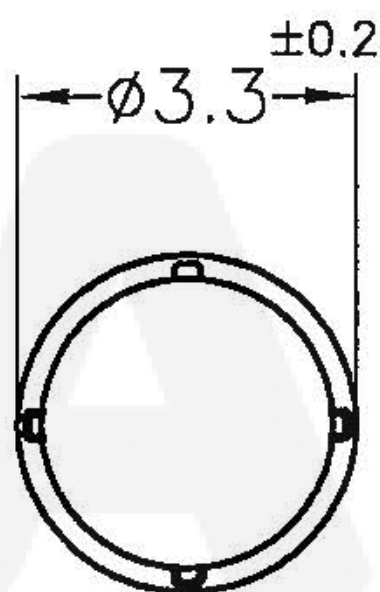
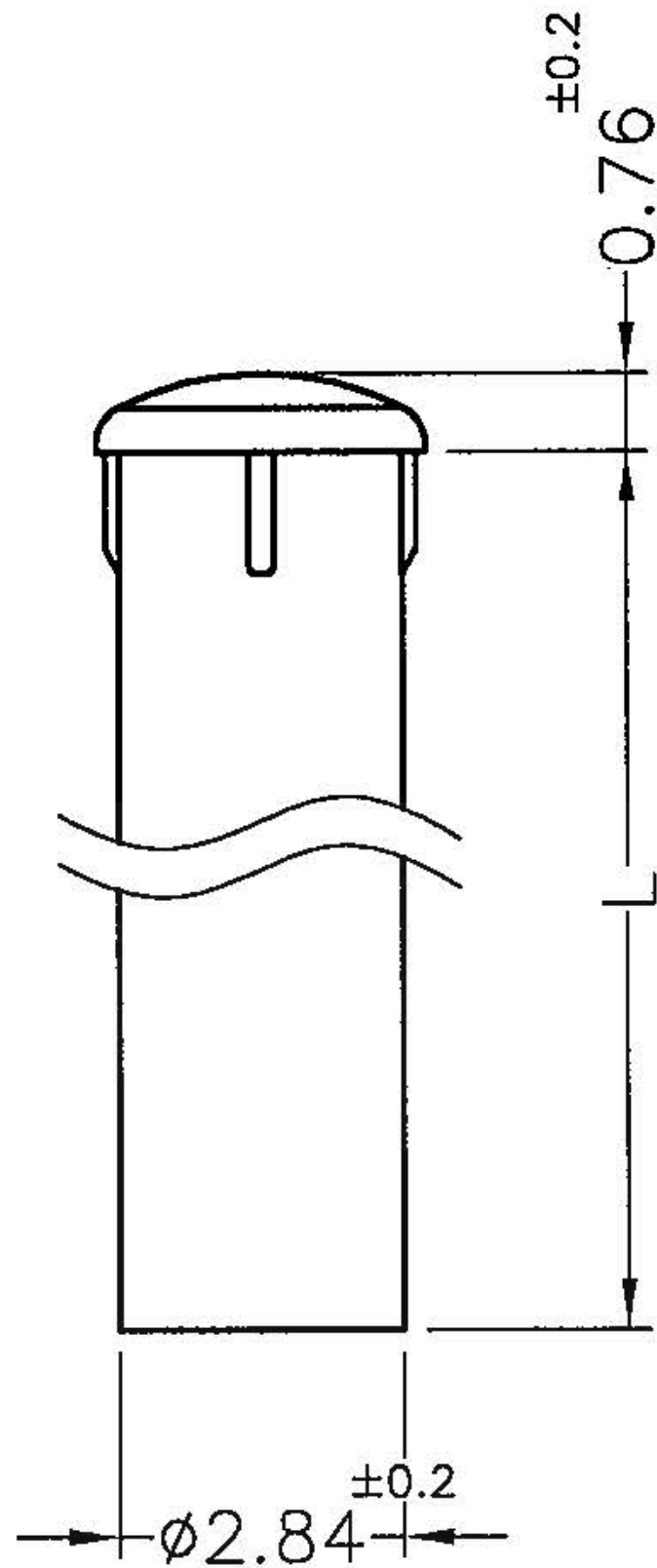

MOUNTING HOLE: $\phi 3.0^{+0.1}_{-0}$ mm
(RECOMMEND FOR REFERENCE ONLY)

PART NO.	L
EMP2-2.5	2.5
EMP2-3.2	3.2
EMP2-4	4.0
EMP2-5	5.0
EMP2-5.5	5.5
EMP2-6	6.0
EMP2-6.4	6.4
EMP2-7	7.0
EMP2-8	8.0
EMP2-8.9	8.9
EMP2-9.5	9.5
EMP2-10	10.0
EMP2-12.7	12.7
EMP2-15.9	15.9
EMP2-19	19.0
EMP2-22.2	22.2
EMP2-24	24.0
EMP2-25.4	25.4
EMP2-30.5	30.5

NOTE:1. MADE OF EQUIVALENT MATERIAL.
2. THE FITTING HOLE DIAMETER IS SUGGESTED, CUSTOMER CAN
ADJUST IT ACCORDING TO THE ACTUAL APPLICATION.

Toby Electronics Ltd sales@toby.co.uk toby.co.uk					
PROPRIETRY AND CONFIDENTIAL The information contained in this drawing is the sole property of Toby Electronics Ltd manufacturing partner. Any reproduction in part as a whole without written permission of Toby Electronics manufacturing partner is strictly prohibited	DATE	2002.01.17	TITLE	LIGHT PIPE	
	DRAWN	JASON	MATERIAL	PC UL94V-0	
	CHECKED	Yuping	COLOR	TRANSPARENT	FINISH
	APPROVED	Kang	UNLESS OTHERWISE SPECIFIED TOLERANCE: SEE ABOVE		
	DO NOT SCALE DRAWING			SCALE: 5:1	UNIT mm
			DWG. NO.	EMP2-HV0	PART NO. SEE ABOVE
			SIZE A4	SPEC. DWG	REV K
			SHEET 1 OF 1		