

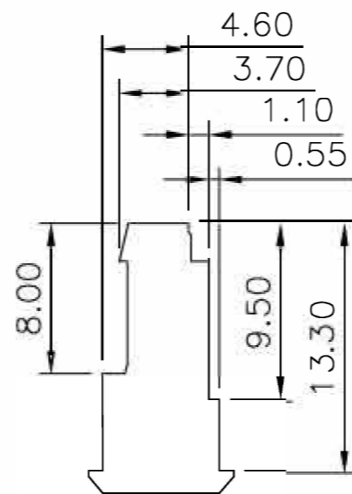

REV	DESCRIPTION	DATE

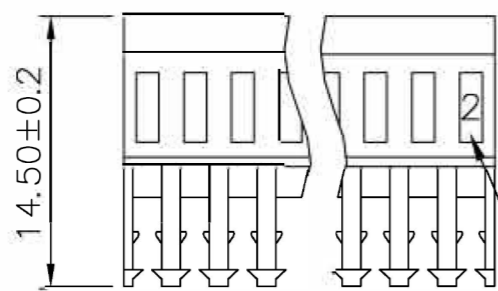
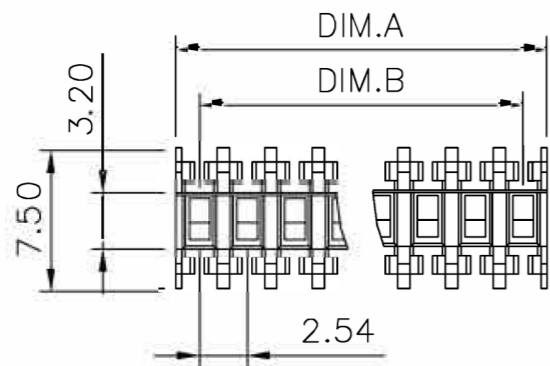

Wire Gauge 2 ⇒ # 22AWG
 4 # 24AWG
 6 # 26AWG
 8 # 28AWG

FEATURES:

- 02~28 Circuits
- Nylon [UL 94V-0]
- Mates with .025" [0.64mm] pins
- Through and end type
- Terminal retention to housing 6.6lbs [3.0kg] minimum

SPECIFICATIONS:

- Current rating: 3A AC, DC
- Voltage rating: 250V AC, Maximum
- Temperature range: -40°C ~ +105°C
- Contact resistance: Initial Value/10m Ω max. After environmental testing /20m Ω max.
- Insulation resistance: 1000 M Ω min
- Withstand voltage: 1500V AC/minute
- Applicable wire: AWG #22 ~ #28

ORDERING INFORMATION:

1600-IDC - $\frac{x}{1} \frac{xx}{2} \frac{x}{3}$

1. Wire Size / Housing Color

2:22# RED 4:24# BLACK
 6:26# BLUE 8:28# GREEN

2. No. of Circuits 02~20

3. T : Tin

Note: Some sizes/types maybe subject to MOQ.

PIN 數	DIM.A	DIM.B	Tolerances
02	5.08	2.54	±0.20
03	7.62	5.08	
04	10.16	7.62	
05	12.70	10.16	
06	15.24	12.70	
07	17.78	15.24	
08	20.32	17.78	±0.25
09	22.86	20.32	
10	25.40	22.86	
11	27.94	25.40	
12	30.48	27.94	
13	33.02	30.48	

PIN 數	DIM.A	DIM.B	Tolerances
14	35.56	33.02	±0.30
15	38.10	35.56	
16	40.64	38.10	
17	43.18	40.64	
18	45.72	43.18	
19	48.26	45.72	
20	50.80	48.26	±0.35
21	53.34	50.80	
22	55.88	53.34	
23	58.42	55.88	
24	60.96	58.42	
25	63.50	60.96	
26	66.04	63.50	±0.38
27	68.58	66.04	
28	71.12	68.58	

Customer Drawing Specific crimp tooling is not available, Crimping can be made with other generic manufacturers tooling.

TOLERANCE		Toby Electronics Ltd			
X.	---	TITLE 4.20mm(.165") Pitch Crimp Housing			
X.X	±0.20				
X.XX	±0.10				
X.XXX	±0.05				
ANGULAR	---				
APPROVALS					
DRAWN	Andy	VIEW	SCALE	PART NO.	REV.
	13-NOV-2019		1:1	1600-IDC-xxxxx	AO
CHECKED	Julia	UNIT	SIZE	DWG NO.	SHEET
	13-NOV-2019	MM	A4	1600-IDC-xxxxx-x-151-C	1 OF 1
APPROVED	Vincent				
	13-NOV-2019				