

# SHUNTS & JUMPERS

(2.54 mm) .100" PITCH • SNT/MNT/2SN/SNM/PK/JL SERIES

## SNT/MNT

### Mates:

TSW, HTSW, MTSW,  
HMTSW, TLW, DW, EW,  
ZW, HW, TSM, BST, PHT

## 2SN

### Mates:

TMMH, TMM,  
MTMM, MMT, TW,  
LTMM, ZLTMM, TSH, EHT

## SNM

### Mates:

TMS, MTMS, DWM

## SPECIFICATIONS

## SNT

### Insulator Material:

Glass Filled Polyester

### Contact Material:

Phosphor Bronze

### Current Rating (SNT/TSW):

4.3 A per pin

(1 pin powered per row)

### Operating Temp Range:

-55 °C to +125 °C

### Insertion Depth:

(4.32 mm) .170" minimum

### Lead Size accepted:

(0.64 mm) .025" SQ

## MNT

Same as SNT except:

### Current Rating (MNT/TSM):

3.9 A per pin

(1 pin powered per row)

### Working Voltage:

450 VAC

## 2SN

Same as SNT except:

### Insertion Depth:

(2.29 mm) .090" minimum

### Lead Size accepted:

(0.51 mm) .020" SQ

## SNM

Same as SNT except:

### Insertion Depth:

(3.43 mm) .135" minimum

### Max Processing Temp:

Not recommended for IR/VP

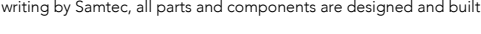
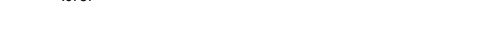
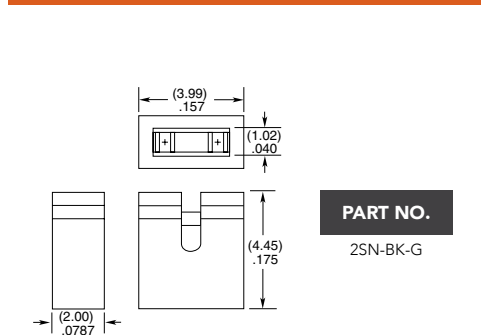
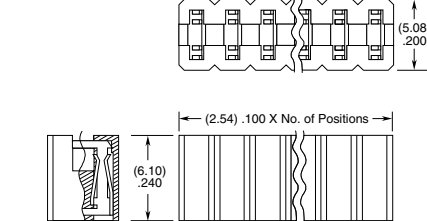
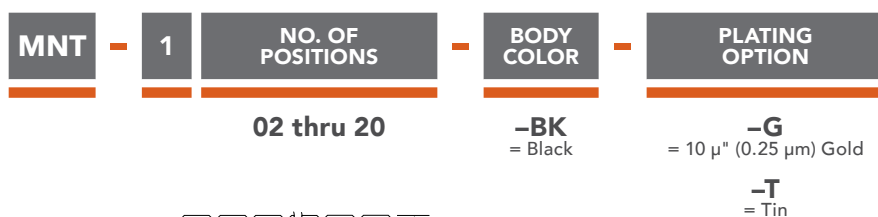
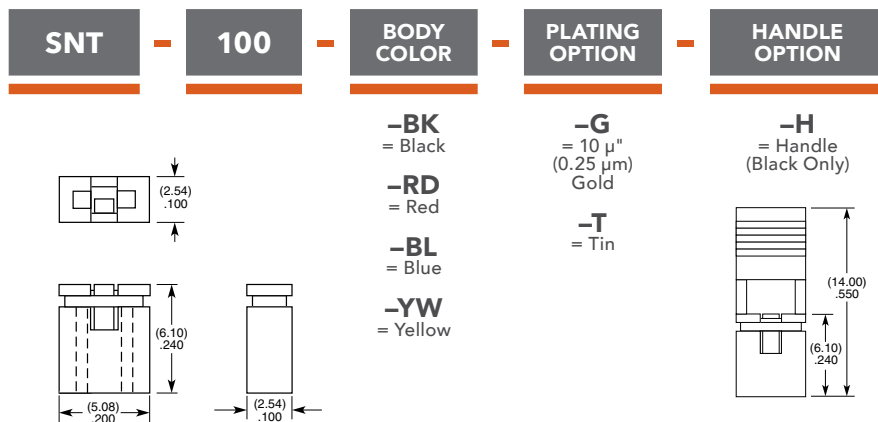

**Note:**  
Other Gold plating options available.

**Note:**  
Some lengths, styles and options  
are non-standard, non-returnable.

## 2SN

## SNM

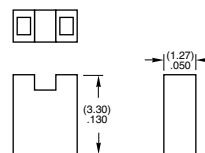

### PART NO.

2SN-BK-G

### PART NO.

SNM-100-BK-G

## JL

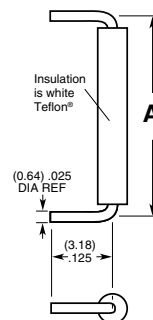

PART NO.	A
JL-100-25-T	(2.54) .100
JL-250-25-T	(6.35) .250
JL-400-25-T	(10.16) .400

## PK

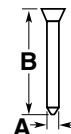

PART NO.	A	B
PK-01-06	(0.64) .025 SQ	(5.84) .230
PK-01-07	(0.51) .020 SQ	(3.18) .125

**Insulator Material:**  
Natural Thermoplastic

**Note:**  
Order per wheel.  
6 pins per wheel.