

REVISION

0	MM	P MASON
8/24/2011	ECN-161328	ISSUE FOR REVIEW
A	JW	P MASON
8/30/2011	ECN-161788	RELEASE FOR PRODUCTION.

NOTES:

1. ITEM 2 IS NOT AVAILABLE AS STANDARD.
2. Ⓢ REPRESENTS A CRITICAL DIMENSION.
3. MINIMUM PUSHOUT FORCE: 3 LBS.
4. MAXIMUM HEIGHT VARIATION BETWEEN ANY TWO POSTS: .005[.13].
5. MAXIMUM CUT FLASH: .010[.25]
6. PARTS TO BE PACKAGED IN BULK.

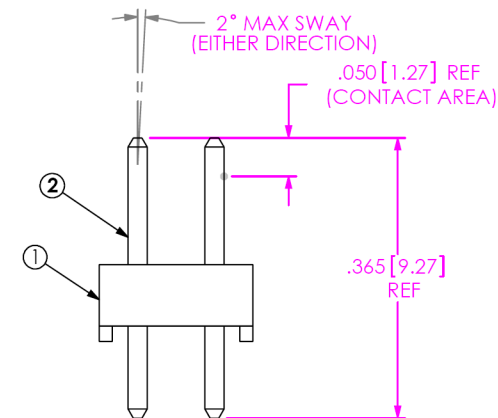
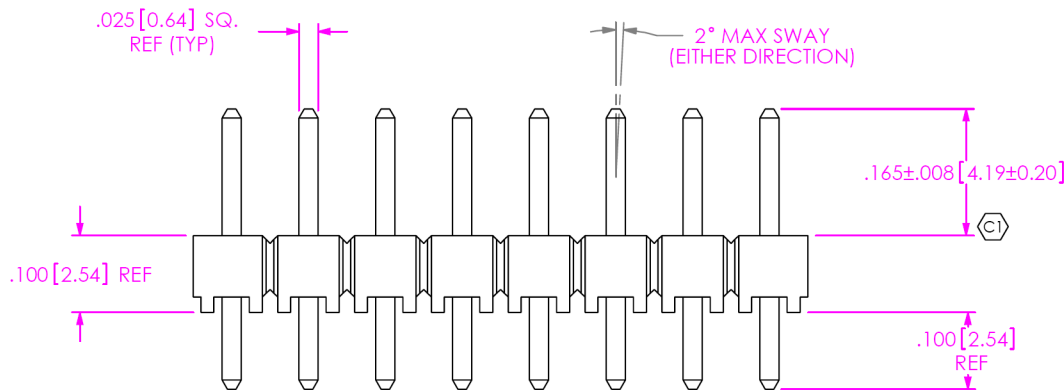
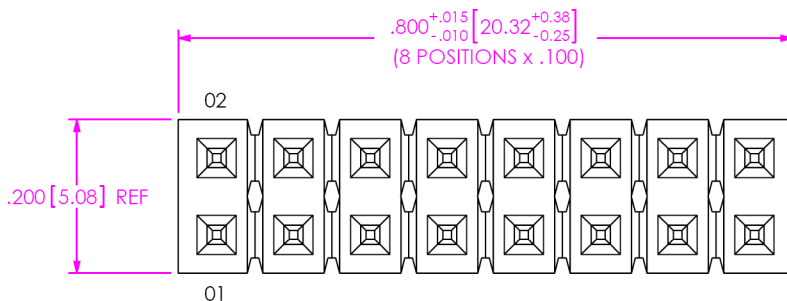
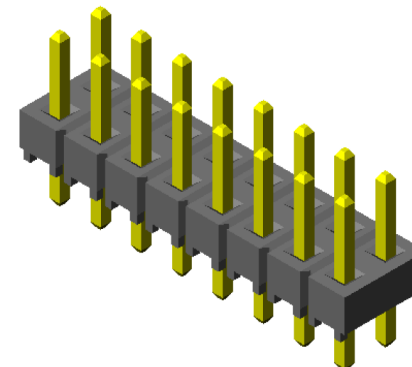

ACCEPTANCE OF DRAWING
ACCEPTED WITH DEVIATIONS LISTED

DATE: _____
COMPANY: _____
CUSTOMER SIGNATURE: _____
PRINTED NAME: _____
PHONE No.: _____
FAX No.: _____

UNLESS OTHERWISE SPECIFIED,
DIMENSIONS ARE IN INCHES.
TOLERANCES ARE:
DECIMALS ANGLES
.XX: ±.01 [.3] 2°
.XXX: ±.005 [.13]
.XXXX: ±.0020 [.051]

PROPRIETARY NOTE
THIS DOCUMENT CONTAINS INFORMATION
CONFIDENTIAL AND PROPRIETARY TO
SAMTEC, INC. AND SHALL NOT BE REPRODUCED
OR TRANSFERRED TO OTHER DOCUMENTS OR
DISCLOSED TO OTHERS OR USED FOR ANY
PURPOSE OTHER THAN THAT WHICH IT WAS
OBTAINED WITHOUT THE EXPRESSED WRITTEN
CONSENT OF SAMTEC, INC.



520 PARK EAST BLVD, NEW ALBANY, IN 47150
PHONE: 812-944-6733 FAX: 812-948-5047
e-Mail: info@SAMTEC.com code: 55322

DO NOT SCALE DRAWING SHEET SCALE: 2:1

PLATING:
CONTACT AREA: .000010 GOLD OVER .000050 NICKEL
REMAINDER: .000003 GOLD OVER .000050 NICKEL

DESCRIPTION:	MTSW ASSEMBLY
DWG. NO.	ASP-165144-01
BY: M MORA	08/24/2011 SHEET 1 OF 1

ITEM NO.	PART NUMBER	QUANTITY	MATERIAL
1	RTSW-50-D	.16600	DUPONT CRASTIN SK652 FR
2	T-1S6-25-G-2	16.000	PHOS BRONZE, 510 3/4 HARD TEMPER

