

Dept	
Qty	
DC	1
ED	1
IE	1
ISO	1
PD	1
R&D	1
SD	1
QA	1
QC	1
QE	1

REV.	DESCRIPTION	DRAWN	CHECKED	APPROVED
A	NEW RELEASE	LL 06/26/06'		LJC 06/26/06'
D	DRAWING UPDATE	JLZ 09/16/19'		

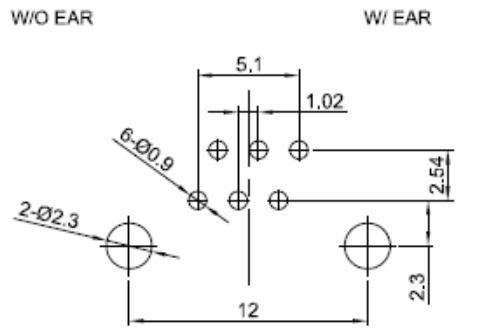

RECOMMEND PCB LAYOUT(TOLERANCE=±0.05)

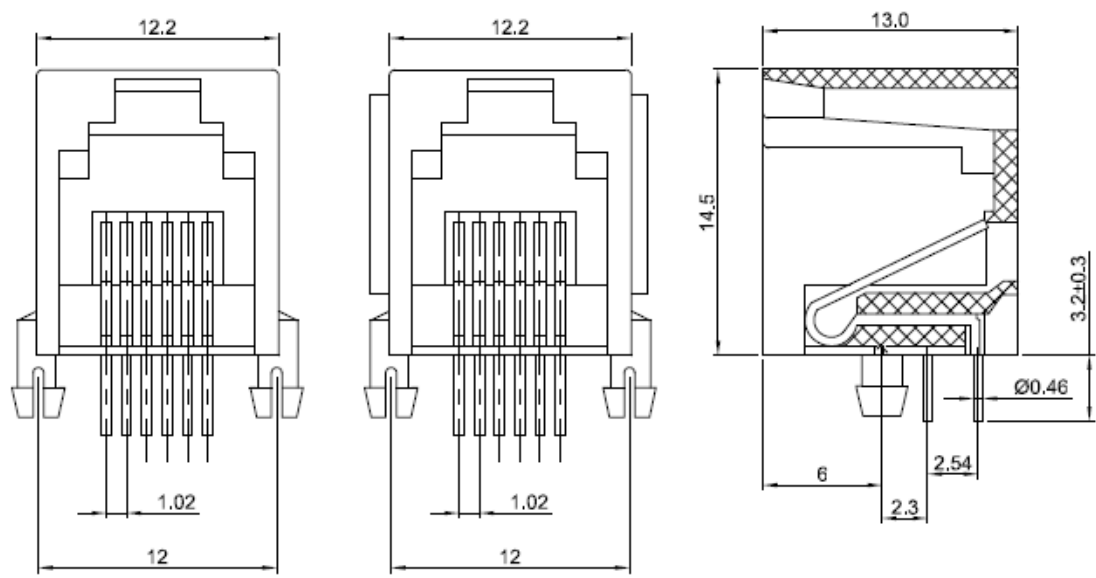
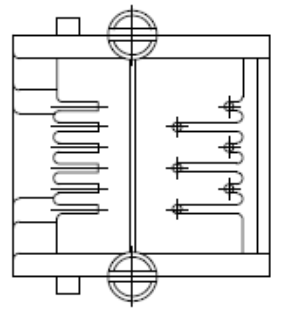

### Ordering Information

#### **VLPSEJ-L-6-6-2-1**

**6 Positions - 6 Contacts - Without Flanges - 6u" Gold Contacts**

**Notes:**

1. Electrical Characteristics:
  - 1.1 Contact Resistance: 20mΩ Max.
  - 1.2 Dielectric Withstanding Voltage: 500V AC(rms) For 1 Minute.
  - 1.3 Insulation Resistance: 1000MΩ Min.
  - 1.4 Current Rating:1.5A.
  - 1.5 Voltage Rating:125V AC rms.
2. Environment Characteristics:
  - 2.1 Temperature: -40°C~+85°C.
3. Materials:
  - 3.1 Contact Material: Copper Alloy.
  - 3.2 Contact Plating: Gold Plating Over Nickel.
  - 3.3 Insulator Materials: PBT/ UL94-V0.

GENERAL TOLERANCE		ANGLE TOLERANCE		PROJECTION		TITLE	PCB Jack 6 Positions W/O Shell Standard Type	
X.	±0.60	X.	±5'	UNITS	mm	SHEET	VLPSEJ SERIES	
.X	±0.38	.X	±3'	SHEET SIZE	A4			
.XX	±0.25	.XX	±2'					
DRAWING TYPE		CUSTOMER		<b>www.toby.co.uk</b>				
SCALE		1:1 SHEET 1 OF 1						
DRAWING NO.		VLPSEJ						



REV.	DESCRIPTION	DRAWN	CHECKED	APPROVED
A	NEW RELEASE	LL 06/24/06'	~	LJC 06/24/06'
B	ADD BLACK	YCH 07/27/07'	~	

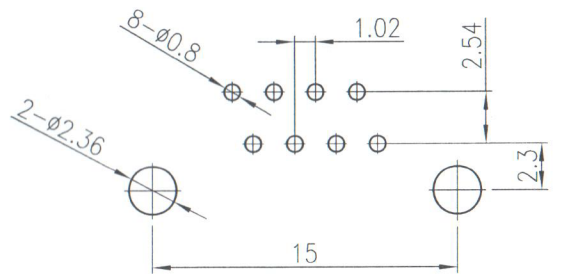
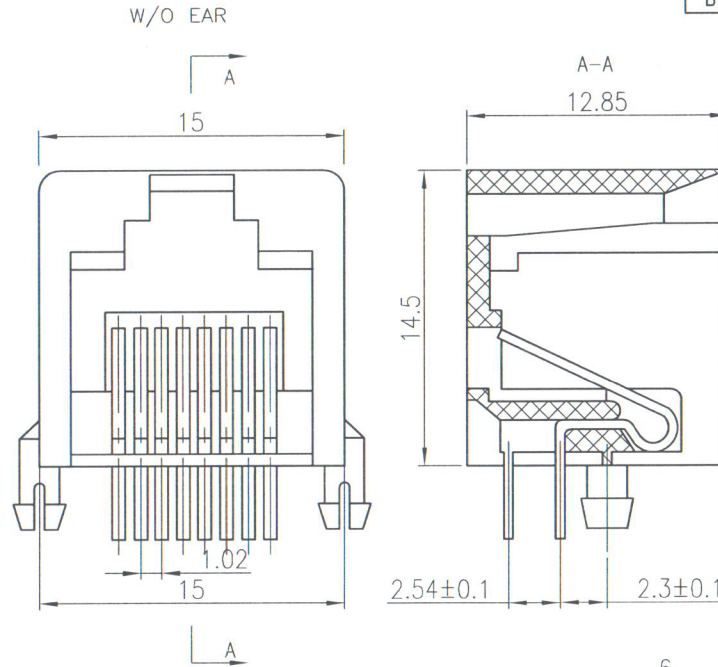

RECOMMEND PCB LAYOUT(TOLERANCE=±0.05)

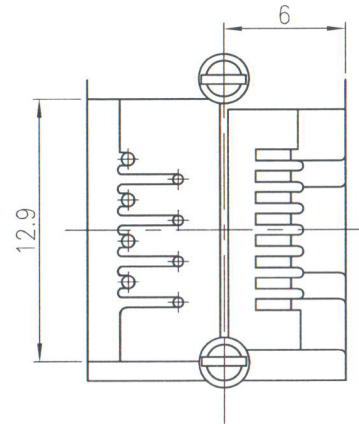

**Ordering Information**

**VLPSEJ-L-8-8-2-1**

8 positions – 8 contacts - Without Flanges - 6μ" Gold Contacts

**Materials**

Housing: Black PBT, UL 94 V-0 or V-2  
Contact: Copper alloy

**Specification**

Insulation Resistance: 1000MΩ Min.  
Withstanding Volatage: 500V AC/Minute  
Durability: 600 mating cycles

GENERAL TOLERANCE		ANGLE TOLERANCE		PROJECTION	TITLE	
X.	±0.60	X.	±5°	mm	PCB JACK 8P	
.X	±0.38	.X	±3°		SHEET SIZE	A4
.XX	±0.25	.XX	±2°		SERIES	VLPSEJ SERIES
DRAWING TYPE		CUSTOMER				
SCALE		1:1 SHEET 1 OF 1				
DRAWING NO.		VLPSEJ-L-8-8-2-1				