

QSFP-1-1-S-LP-F

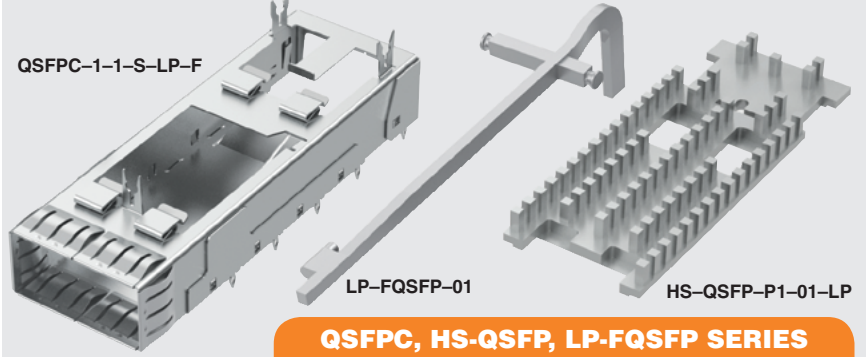

LP-FQSFP-01

HS-QSFP-P1-01-LP

QSFP, HS-QSFP, LP-FQSFP SERIES

FQSFP CAGE, HEAT SINK & LIGHT PIPE

SPECIFICATIONS

QSFP	CAGE OPTION	NO. OF PORTS	EMI PANEL OPTION	OPTION	FLYOVER
	-1 =Single Stack	-1 = One Port -2 = Two Ports	-S = Spring Fingers	(Leave blank for no Light Pipe) -LP = Light Pipe (1 port only) -N = No heat sink closed top (Not available with -LP)	(Leave blank for no flyover) -F = Flyover

TOOLING

- Press-Fit
CAT-PT-FQSFP-03

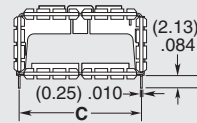
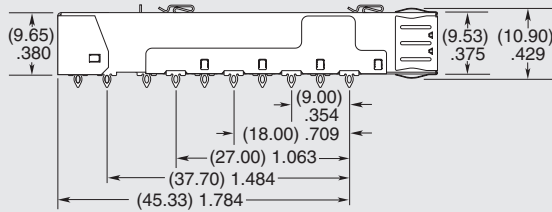
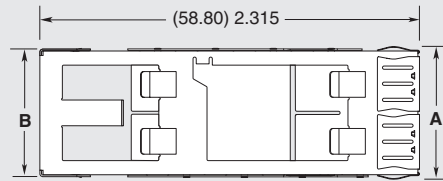

NO. OF PORTS	A	B	C
-1	(20.62) .812	(19.85) .781	(19.00) .748
-2	(39.62) 1.560	(38.85) 1.530	(38.00) 1.496

QSFP-1-1-S-F SHOWN

Note:
Some lengths, styles and options are non-standard, non-returnable.

HS-QSFP

HEAT SINK STYLE

HEAT SINK HEIGHT

LIGHT PIPE

-P1
= Pin
(Aluminum)

Specify HEAT SINK HEIGHT from chart

(Leave blank for no Light Pipe)
-LP
= Light Pipe

HEAT SINK HEIGHT	A
-01	(4.20) .165
-02	(6.50) .256
-03	(13.50) .531
-04	(1.50) .059

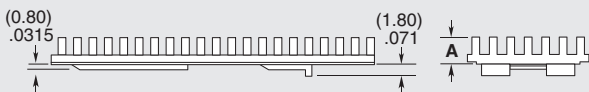
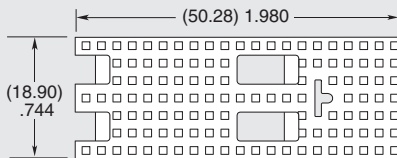

HS-QSFP-P1-01 SHOWN

LP

FQSFP

NO. OF PORTS

-01 = One Light Pipe
-02 = Two Light Pipes
-04 = Four Light Pipes

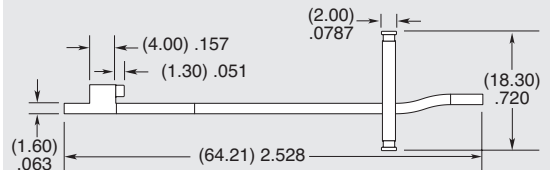

LP-FQSFP-01 SHOWN

Due to technical progress, all designs, specifications and components are subject to change without notice.

www.toby.co.uk

All parts within this catalog are built to Samtec's specifications.
Customer specific requirements must be approved by Samtec and identified in a Samtec customer-specific drawing to apply.