

SMP-J-B-GF-ST-1450



SMP-J-C-GF-RA-CA7



SMP-PF-P-HH-ST-EM3



SMP-PF-P-GF-ST-TH2



SMP-J-C-GF-ST-CS5



SMP-J-B-GF-ST-0645



SMP SERIES

50 Ω SMP JACKS/PLUGS & ADAPTOR

SMP-PF, SMP-PL,
SMP-PS, SMP-PC

Mate with:

SMP-B Bullet Adaptor

Cable Mates:

RF405, RF25S

SPECIFICATIONS

For complete specifications :

ASK JIM

ASKJIM@TOBY.CO.UK

Sales@toby.co.uk

www.toby.co.uk

Shell Material:

Au plated Brass (-TH2, -EM3)

Au plated BeCu (-J-B, -J-C)

Contact Material:

Brass (-TH2, -EM3)

BeCu (-CA)

Insulator Material:

PTFE

Impedance:

50 Ω

Frequency Range:

DC to 40 GHz,

DC to 20 GHz (25 AWG)

Working Voltage:

335 Vrms min

Dielectric Withstanding:

500 Vrms min

Engagement Force:

-PF: 15 lbs. max

-PL: 10 lbs. max

-PS & -PC: 2 lbs. max

Disengagement Force:

-PF: 2 lbs. min

-PL: 2 lbs. min

-PS & -PC: 0.5 lbs. min

Operating Temperature:

-65 °C to +165 °C

RoHS Compliant:

Yes

PROCESSING

Lead-Free Solderable:

Yes

ALTERNATIVE SOLUTIONS

The SMP Series is an alternative to the Corning Gilbert GPO Series.

The SMPM Series is in development.

Note:

While optimized for 50 Ω applications, this connector can also perform well in certain 75 Ω applications.

SMP

GENDER

TYPE

PLATING

ORIENTATION

TERMINATION

-PF

= Plug, Full Detent

-PL

= Plug, Limited Detent

-PS

= Plug, Smooth Bore

-PC

= Plug, Catcher's Mitt

-P

= PCB Mount

-GF

= 10 μm (0.25 μm)

Gold center contact, Gold Flash outer contact (-TH2 only)

-HH

= 30 μm (0.76 μm)

Gold center and outer contact (-EM3)

-ST

= Straight

GENDER	A DIA
-PF	(4.19) .165
-PL	(4.19) .165
-PS	(5.99) .236
-PC	(5.99) .236

-TH2

= Through-hole

-EM3

= Drop-in Edge Mount (Not available with -PC)

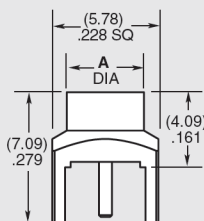

-PF/-PL/-PS/-TH2

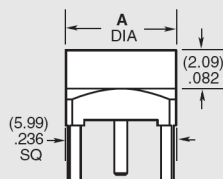

-PC-TH2

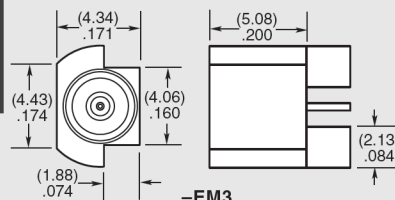

APPLICATION

LENGTH	BOARD SPACE
-0645	(9.05) .356
-1450	(17.10) .673

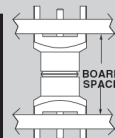

EXTRACTION TOOL

- CAT-EX-SMP-01
- Contact Samtec

SMP

J

TYPE

PLATING

ORIENTATION

BULLET LENGTH

CABLE END

-B

= Bullet Adaptor

-C

= Cable End

-GF

= 10 μm (0.25 μm)

Gold center contact, Gold Flash outer contact

-ST

= Straight

-RA

= Right-angle (Not available with -B)

Leave blank for cable end

-0645

= 6.45 mm (.254")

-1450

= 14.50 mm (.571")

Leave blank for bullet type

-CA7

= RG 405 (.086" DIA) Semi-flexible Cable

-CS5

= MWC-2550-01 25 AWG Microwave Cable

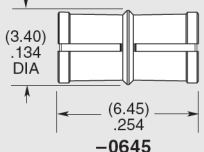

-0645

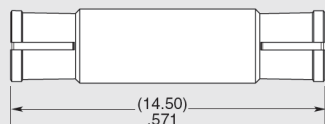

-1450

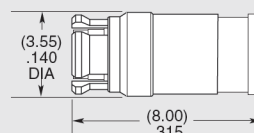

-ST-CXX

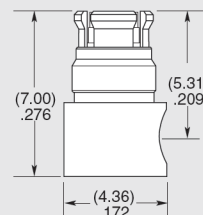

-RA-CXX

Due to technical progress, all designs, specifications and components are subject to change without notice.

WWW.TOBY.CO.UK

All parts within this catalog are built to Samtec's specifications.

Customer specific requirements must be approved by Samtec and identified in a Samtec customer-specific drawing to apply.