

SPECIFICATIONS:

CONTACT RATING: DC 12V 0.5A.
CONTACT RESISTANCE: 30m Ω max.
MECHANICAL LIFE: 1,000 cycles.
INSULATION RESISTANCE: 500M Ω min. at 500VDC.

MATERIALS:

HOUSING: Nylon 6/6 (UL94V-0).
SLIDE HANDLE: Nylon 6/6 (UL94V-0).
TERMINAL: Brass, gold over nickel plated.

Specifications and Dimensions subject to change

If your preferred product configuration is not shown, please contact our sales representative for custom design.

HOW TO ORDER:

V1K2-xx

1.

1. xx = PCB Mounting Type

S = Vertical Through Hole

R = Right Angle Through Hole

SM = SMT Vertical

Toggle

Rocker

Slide

Pushbutton

AV

Rotary

Tact

Touch Key

Miscellaneous

P.C.MOUNTING

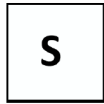

Term.
Comm.

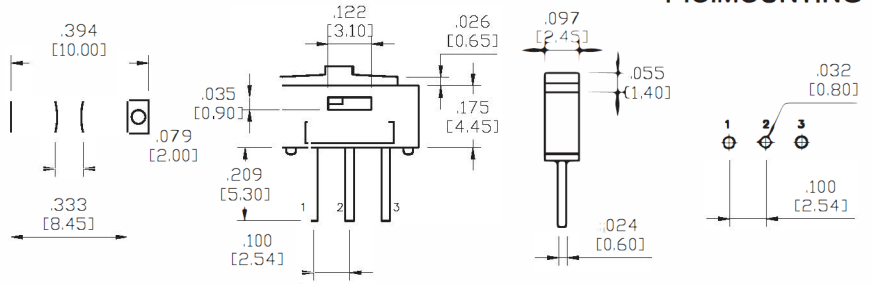
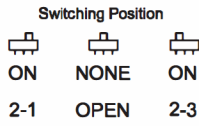

SPDT

P.C.MOUNTING



Term.
Comm.

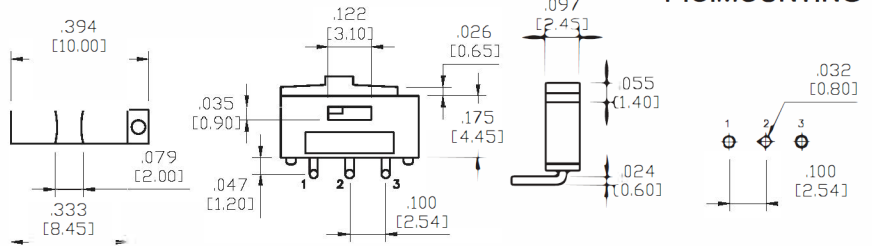
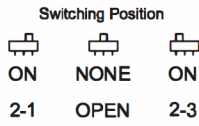

SPDT

P.C.MOUNTING



Term.
Comm.

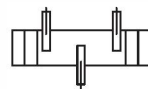
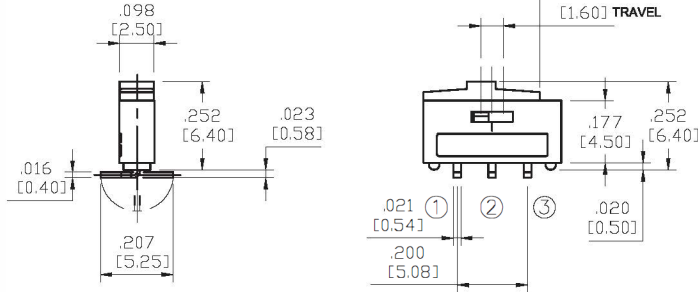
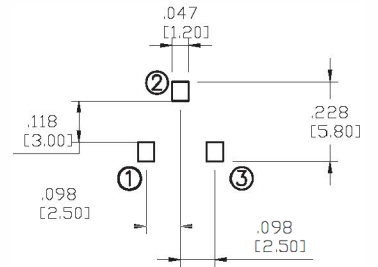
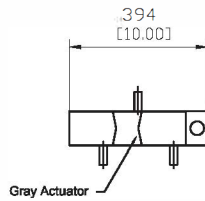
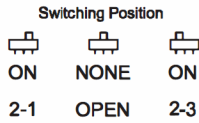

SPDT

Contact & Terminal Material

Brass with gold plating

Rating

0.5A @ 12VDC